



SPECIAL FEATURES

- DIAPHRAGM DIRECTLY WELDED TO TOP CHAMBER
- TWO PIECE CONSTRUCTION
- IDEAL FOR GENERAL PURPOSE APPLICATION
- ROBUST DESIGN
- ALL SS CONSTRUCTION



APPLICATIONS

DIAPHRAGM SEALS ARE PROVIDED IN THE INSTRUMENTS LIKE PRESSURE GAUGES, SWITCHES, TRANSMITTERS IN ORDER TO ISOLATE THE SENSING ELEMENT FROM THE MAIN SERVICE DUE TO ITS CORROSIVE, VISCOUS AND SEDIMENTED NATURE AND TO AVOID CLOGGING AND SOLIDIFICATION.

SPECIFICATIONS

STANDARD VERSION

Range	: -1 kg/cm ² to 70 kg/cm ²
Process Temperature	- 40°C to 200°C or as per fill fluid
Instrument Connection	: 3/8" BSP (F)
Process Connection	: 1/2"NPT (M)
Fill Fluid	: Silicon Oil - DC 200

Diaphragm	: AISI 316L SS
Top Chamber	: AISI 316 SS (Forged)
Bottom Chamber	: AISI 316 SS (Forged)
Nuts / Bolts	: AISI 304 SS
Gasket	: PTFE (upto 200° C)/Metal Seal (upto 350°C)

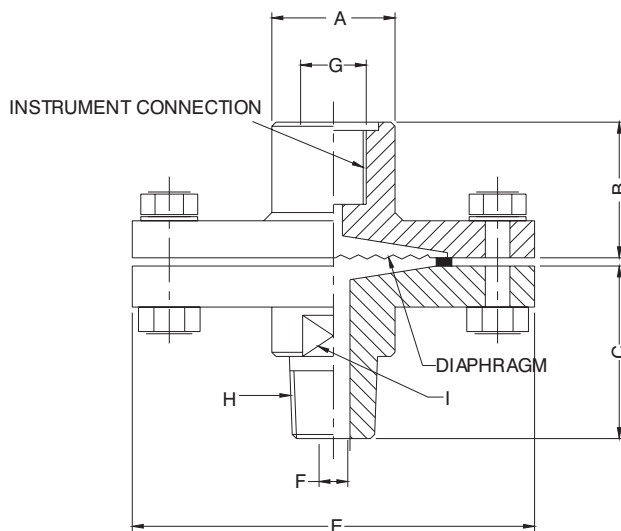

A	~B	~C	E	F	G	H	I
30	25	47	98	Ø8	3/8" BSP(F)	*	A/F 25

* As Per Customer Requirement.

Notes : • Drawings are not to scale. • All Dimensions are in mm.

HOW TO ORDER**BASIC MODEL**

DB

OPTIONS

FOR NON STANDARD PRODUCTS/OPTIONAL ITEMS, PLEASE CONTACT FACTORY FOR DELIVERY AND MINIMUM QUANTITY OF ORDER.

TOP CHAMBER

YA AISI 316L SS

YA

DIAPHRAGM

UJ AISI 316L SS UN NICKEL UR TITANIUM

UJ

UL HASTELLOY 'C' UP SILVER

UM MONEL UQ TANTALUM

GASKETS

VI PTFE SEAL GASKET 200° C YR METAL SEAL

VI

PROCESS CONNECTION

WC 3/8" BSP(F) WH 1/2" NPT (F) WS 1/4" BSP(M)

WD 1/2" BSP(F) WI 1/4" NPT (F) WZ 3/8" NPT(M)

WE 1/4" BSP(F) WT 3/8" BSP (M) WY 1/4" NPT(M)

WG 3/8" NPT(F) WU 1/2" BSP(M) WA 1/2" NPT(M)

WU

Note : Connections like PT/PF/Flaired /UNF/G/R etc.can be provided on request.**The material of adaptor is same as per bottom chamber material.****INSTRUMENT CONNECTION**

VL 1/2" BSP(F) VN 1/4" BSP(F) VO 1/4" NPT (F)

VM 1/2" NPT (F) VQ 3/8" NPT(F) VP 3/8" BSP (F)

VP

BOTTOM CHAMBER

TM AISI 316 SS

TM

NUTS & BOLTS FOR SEALED CHAMBER CLAMPING

VW AISI 304 SS

VW

FLUSHING RING

VC FLUSHING RING WITH 1/2"NPT PLUG (AISI 304 SS) VE FLUSHING RING WITH 1/4"NPT PLUG (AISI 304 SS)

VD FLUSHING RING WITH 1/2"NPT PLUG (AISI 316 SS) VF FLUSHING RING WITH 1/4"NPT PLUG (AISI 316 SS)

VF

FILLING FLUIDS

US FLUROLUBE 4.2 [-45 TO 175°C / -49 TO 374° F]

UY SILICON DC 704 [0 TO 315°C / 32 TO 599° F]

UT FLUROLUBE 6.3 [-40 TO 235°C / -40 TO 455° F]

UZ SILICON DC 710 [5 TO 345°C / 41 TO 653° F]

UU FLUROLUBE FS5 [-40 TO 150°C / -40 TO 302° F]

VA SYLTHERM 800 [-45 TO 205°C / -49 TO 401° F]

UV FOOD GRADE OIL [-20 TO 140°C / -4 TO 284° F]

VB SYLTHERM XLT [-75 TO 150°C / -102 TO 302° F]

UX SILICON DC 200-10CS [-40 TO 205°C / -40 TO 401° F]

VC HALOCARBON OIL

UX

PROTECTION ON WETTED PARTS

VS PTFE LINING ON BOTTOM CHAMBER- 2mm THICK

VV PTFE PROTECTION FOR DIAPHRAGM

TYPE

VZ PTFE COATING ON DIAPHRAGM

VV

A0 WITHOUT CAPILLARY

A1 WITH CAPILLARY

A1

CAPILLARY

PE AISI 304 SS

PG AISI 316 SS

PE

CAPILLARY COVERED WITH ARMOUR

PF AISI 304 SS

PH AISI 316 SS

PI PVC

PF

CAPILLARY LENGTH(Max up to 6Mtrs.)

IN METERS (e.g. 1.5 = 1.5 METERS 2.0 = 2 METERS)

3Mtr.

OTHER OPTIONS

TB HELIUM LEAK TEST TC DRY SEAL ONLY WITHOUT INSTRUMENT

TC

Ordering Example:

DB - YA - UJ - VI - WU - VP - TM - VW -VF- UX - VV - A1 - PE - PF - 3Mtr. - TC

Note : ● Due to continuous improvement, the specification may vary from time to time.