

# MF-101 SERIES

'Medium Flow' Pressure Reducing Regulator // Piston Sensed for Medium Pressure Applications

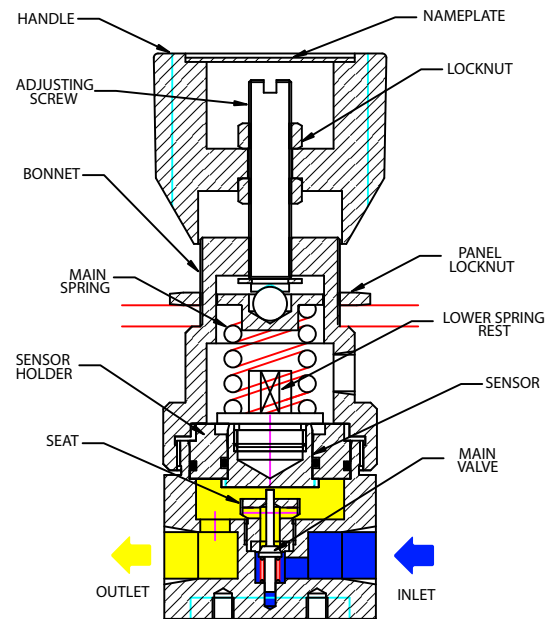

\*Assembly drawing for reference only. Refer to office for specific detail.

The MF-101 incorporates a large precision machined sensing element to control outlet pressures up to 35bar from a maximum 100bar inlet. The main valve is an unbalanced design to create positive shut off on gas or liquid applications against the PEEK seat.

## APPLICATIONS:

- Gas and Liquid Analyzer Systems
- Low Pressure Hydraulic Systems
- Research labs
- Instrument Air Lines

## FEATURES:

Lightweight compact design  
Piston sensing element  
High accuracy

## STANDARD MATERIALS OF CONSTRUCTION

Regulator part	Material
Body and Bonnet	316SS
Main valve pin	316SS
Soft seat cone	PEEK or PCTFE
Valve spring	Inconel X750
Sensor and holder	316SS
Handwheel	Nylon
Spring rests	316SS
'O' ring seals	Viton
Adjusting screw	Alu Bronze
Loading Spring	302SS

NOTE: Product availability and specifications contained herein are subject to change without notice. Consult local distributor or factory for potential revisions and/or service related issues. // pg 1 of 2

PRESSURE TECH LTD, Unit 6, Graphite Way, Hadfield, Glossop, Derbyshire SK13 1QG  
Tel: +44 (0)1457 899307 Fax: +44 (0)1457 899308  
e-mail: info@pressure-tech.com

[www.pressure-tech.com](http://www.pressure-tech.com)



Designed and built in the UK



# MF-101 SERIES

'Medium Flow' Pressure Reducing Regulator // Piston Sensed for Medium Pressure Applications

## INSTALLATION DIMENSIONS:

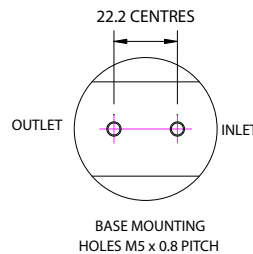
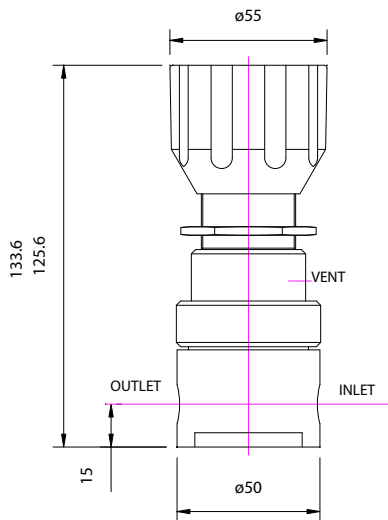

## SPECIFICATION :

Max rated inlet pressure .....100bar (1450psi)  
 Outlet ranges ..... 0 – 10bar, 0 – 20bar, 0 – 35bar  
 Design Proof pressure ..... 150% max WP  
 Leakage .....Bubble tight at max WP  
 Weight ..... 0.9kg (2lbs)

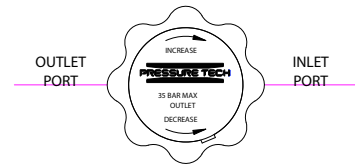
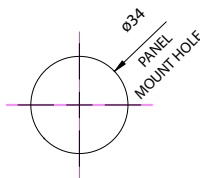

## ORDERING INFORMATION:

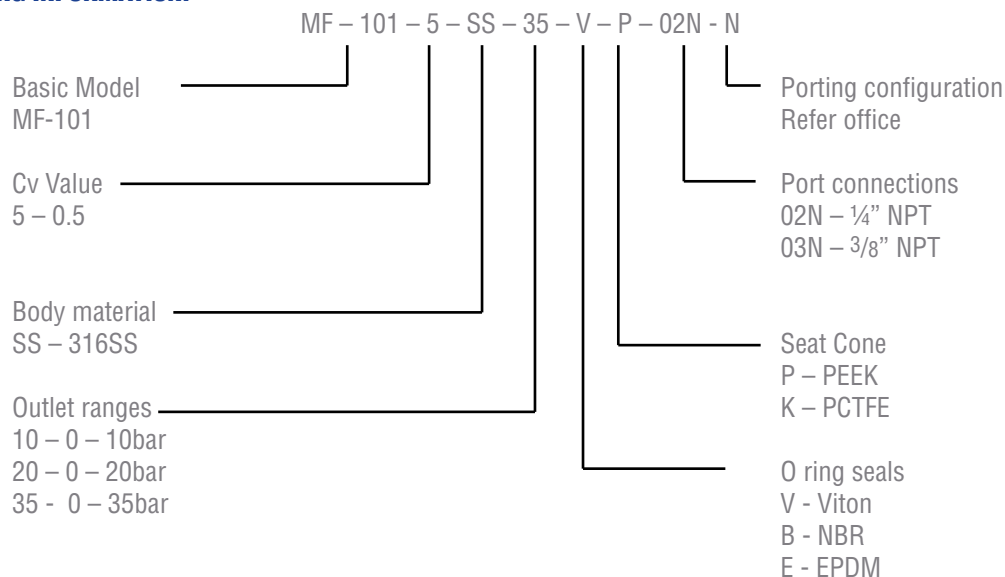

NOTE: Product availability and specifications contained herein are subject to change without notice. Consult local distributor or factory for potential revisions and/or service related issues. // pg 2 of 2